

# NEATH PORT TALBOT COUNTY BOROUGH COUNCIL

## Environment and Highways Cabinet Board

28 January 2016

### Report of the Head of Engineering & Transport

D. W. Griffiths

#### Matter for Decision

**Ward Affected:** Margam

#### Proposed Traffic Regulation Order Cramic Way, Port Talbot

#### Purpose of Report

- 1 To consider the objections received following the advertisement of the proposals as indicated in Appendix A.

#### Executive Summary

- 2 Two objections were received in respect of the proposal.
- 3 The report outlines the objections and the recommendation for the scheme

#### Background

- 4 Following the construction of the new Harbourside car park in association with the Port Talbot Parkway redevelopment it is proposed that a prohibition of waiting, loading and unloading at any time and a 1 hour limited waiting bay be implemented on Cramic Way and Oakwood Road.
- 5 It was also noted that Cramic Way is an unlit road, therefore, a legal 30mph speed limit order is required.
- 6 In December 2015 the proposals were advertised and at the same time a consultation exercise was undertaken to all properties directly affected by the scheme – Appendix B.

- 7 Screening Assessment has been undertaken to assist the Council in discharging its Public Sector Equality Duty under the Equality Act 2010. After completing the assessment it has been determined that this function does not require an Equality Impact assessment.

### **Financial Implications**

- 8 The work will be funded from the capital works programme 2015/16.

### **Equality Impact Assessment**

- 9 Not required.

### **Workforce Impact**

- 10 Not applicable.

### **Legal Impact**

- 11 The scheme was advertised for a 21 day period.

### **Risk Management**

- 12 There are no service risk management issues associated with this scheme.

### **Consultation Outcome**

- 13 List of Consultees:-

Councillor R G Jones  
Businesses affected by the proposals

- 14 As part of the consultation exercise, a letter drop was undertaken to all businesses within the immediate vicinity of the proposals. During the consultation process two letters of objection were received;

- 15 Business 1 stated that their burger van has traded on Cramic Way for the last 27 years and that the proposed traffic order would have a detrimental affect on their livelihood.

- 16 Business 1 currently has a trading licence to operate on the highway. The proposed traffic regulation order would prevent their burger van from parking on the highway meaning they would have to cease trading.
- 17 Business 2 stated that they strongly object to the proposed traffic order as it is directly outside of the business and is used by employees and customers to park their vehicles. It was also stated that the proposed traffic order would have an adverse effect on the business and requested an amendment to the scheme to include private or permit parking.
- 18 Business 2 does not have enough off-street parking to accommodate all of their customers who currently park on the highway outside of the business. The proposed traffic regulation order would limit the waiting time to 1 hour for customers who sometimes require a longer stay so would have a detrimental effect on business.

### **Recommendation**

- 19 It is recommended that:-
- 20 The objections be upheld in part and that approval is given for the revised scheme to be advertised as indicated on the attached plans (Appendix C & Appendix D) and subject to there being no objections, for the Order to be implemented.
- 21 That the objectors to be informed accordingly.

### **Reasons for Proposed Decision**

- 22 To allow Business 1 and 2 to continue to trade, whilst at the same time preventing indiscriminate parking in the interest of road safety within the immediate vicinity of the new Parkway Station.
- 23 To legalise the 30mph speed limit for Police enforcement.
- 24 The decision is proposed for implementation after a three day call-in period.

## **Appendices**

- Appendix A – Legal drawing
- Appendix B – Consultation Letter
- Appendix C – Revised Drawing
- Appendix D – Speed Limit Drawing

## **List of Background Papers**

- 25 File TR25

## **Officer Contact**

- 26 Mr D L Long – Senior Technician Traffic  
Tel.No. 01639 686488  
email: [d.long@npt.gov.uk](mailto:d.long@npt.gov.uk)
- 27 Mr M Brumby – Project Manager Highways  
Tel No. 01639 686013  
email: [m.brumby@npt.gov.uk](mailto:m.brumby@npt.gov.uk)

# Appendix A

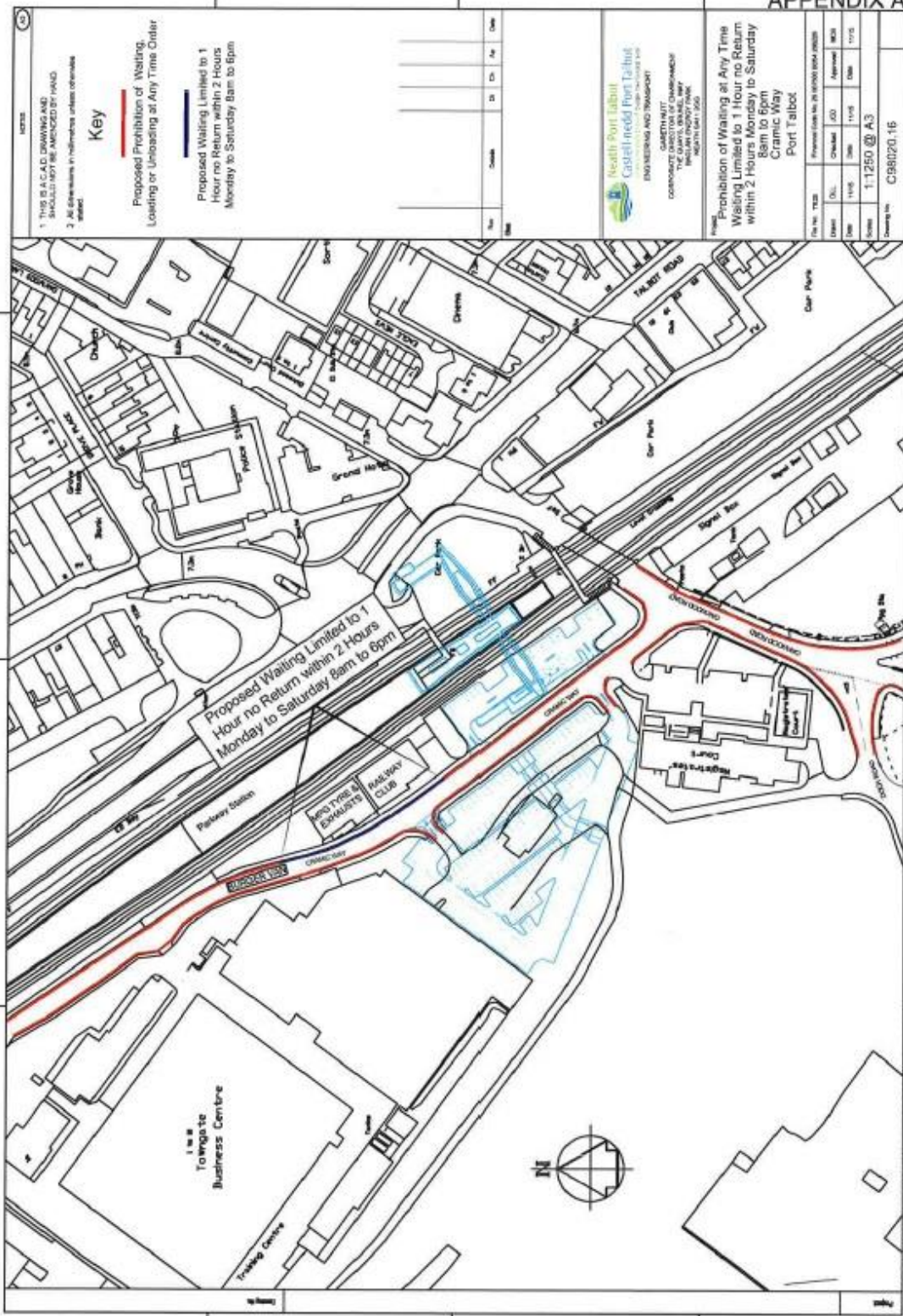

## Appendix B



16 December 2015  
01639 686013  
[m.brumby@npt.gov.uk](mailto:m.brumby@npt.gov.uk)

Date Dyddiad  
Direct Line Rhif Ffôn  
email eboist

Mr M C Brumby

TR25/MCB/JW

Contact Cyswllt  
Your Ref Eich Cyf  
Our Ref Ein Cyf

The Occupier

FR Appendix B

Dear Sir/Madam

**Re:- Prohibition of Waiting, Loading or Unloading at Any Time and Waiting Limited to 1 Hour No Return Within 2 Hours, Monday to Saturday, 8am to 6pm – Cramic Way, Dock Road and Oakwood Road, Port Talbot**

It is the intention of Neath Port Talbot County Borough Council to implement the Prohibition of Waiting, Loading or Unloading at Any Time and Waiting Limited to 1 Hour No Return within 2 Hours, Monday to Saturday, 8am to 6pm Order as indicated on the attached plan.

A copy of the proposed Order, Statement of Reasons and an appropriate plan may be inspected during normal office hours at the main reception desks in the Civic Centres at Neath and Port Talbot, The Quays, Baglan and Pontardawe Library.

Any comments should be submitted in writing to reach the Head of Engineering and Transport, Neath Port Talbot County Borough Council, The Quays, Brunel Way, Baglan Energy Park, Neath SA11 2GG by 6<sup>th</sup> January 2016.

Should you require any further information please contact my officer on the above telephone number.

Yours faithfully

  
For HEAD OF ENGINEERING & TRANSPORT

Environment  
Yr Amgylchedd

[www.npt.gov.uk](http://www.npt.gov.uk)

David W Griffiths  
Head of Engineering & Transport  
The Quays, Brunel Way, Baglan Energy Park,  
Neath SA11 2GG  
Tel: 01639 686868 Fax: 01639 686100

The Council welcomes  
correspondence in English or Welsh

David W Griffiths  
Pennaeth Peirianneg a Chludiant  
Y Ceiau, Ffordd Brunel, Parc Ynni Baglan,  
Castell-nedd SA11 2GG  
Ffôn 01639 686868 Ffacs 01639 686100

Mae'r Cynghor yn croesawu gohebiaeth  
yn y Gymraeg neu'r Saesneg





# Appendix D

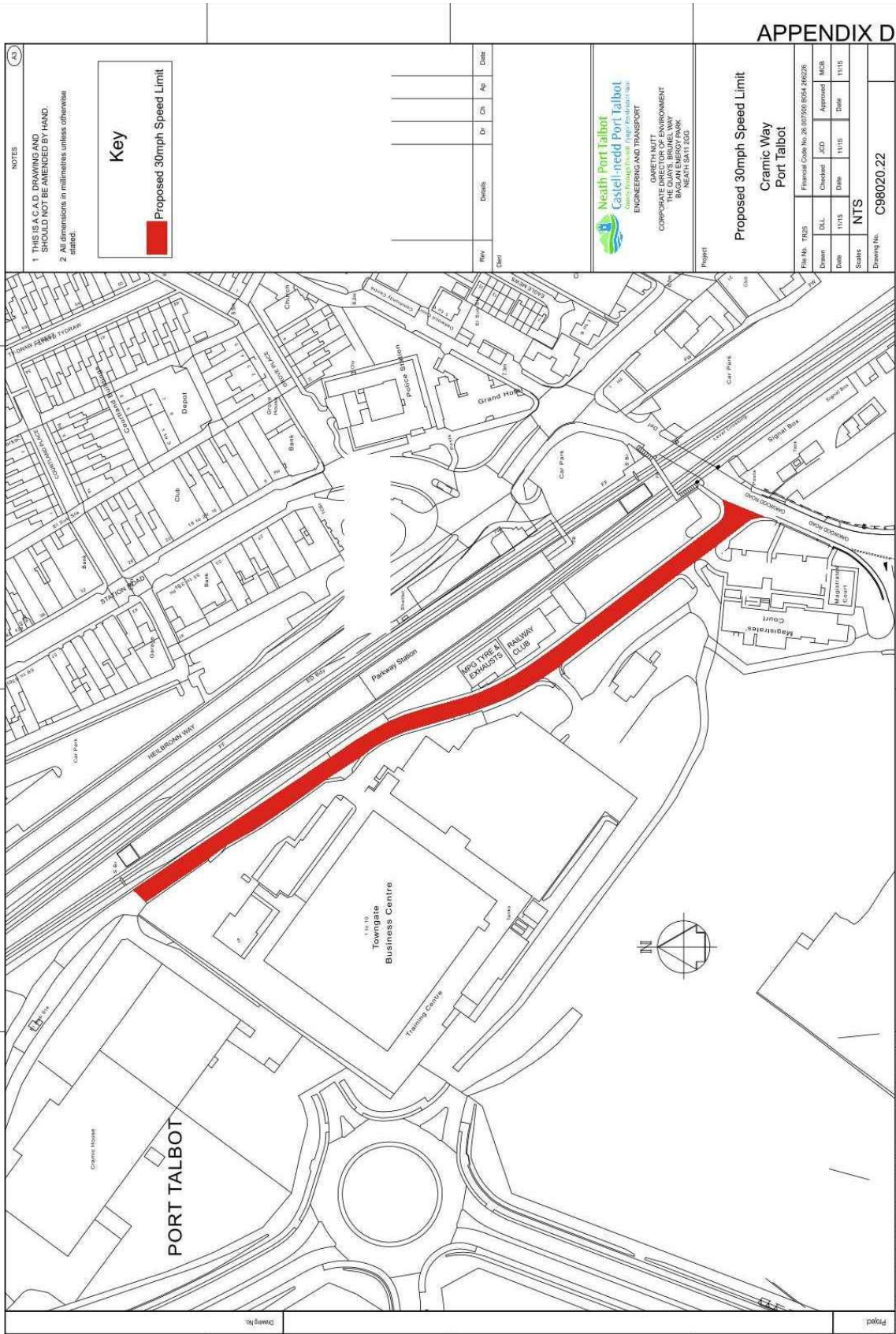

**NOTES**

1 THIS IS A C.A.D. DRAWING AND SHOULD NOT BE AMENDED BY HAND.

2 All dimensions in millimetres unless otherwise stated.

**Key**

Proposed 30mph Speed Limit

Rev	Details	Dr	Ch	Ap	Date

**Neath Port Talbot**  
**Castell Llewellyn Port Talbot**  
 Neath Port Talbot Council  
 ENGINEERING AND TRANSPORT

GARETH MITT  
 CORPORATE DIRECTOR OF ENVIRONMENT  
 THE CLAWNS, BRUNEL WAY  
 PORT TALBOT, NEATH SA11 2GG

**APPENDIX D**

Proposed 30mph Speed Limit  
 Ceramic Way  
 Port Talbot

File No.	7152	Filename	Ceramic Way 20.07.2008 05:54 200208
Drawn	DLL	Checked	JCD
Date	01/11	Date	01/11
Scale	NTS	Approved	MCS
Drawing No.	C98020.22	Date	01/11